

HSF

TECHNICAL SPECS:

Current Rating: 1.0AMP
 Contact Resistance: 10m Ω Max
 Dielectric Strength: Min 1000Vrms
 Mechanical Life: Min 500 cycles
 Mating Pin: $\phi 0.38$ to $\phi 0.50$ mm
 Forces: (polished steel gauge $\phi 0.41$ mm)
 Insertion: 150g Max/Pin, Withdrawal: 30g Min/Pin
 Operation Temperature: -40°C to +105°C

Sleeve: Brass CuZn36Pb3(C36000), Sn over Ni
 Contact Clip: (6 finger); BeCu(C17200), Au or Sn over Ni
 Insulator Material: PPS+30%G.F.(UL94V-0)

Ordering Information

3523-301 XX S XX 074 X 1

No. of Pin 2-50PIN
 Contact Plating S0=Gold Flash/Tin
 S3=10u"Gold/Tin
 S4=15u"Gold/Tin
 S5=30u"Gold/Tin
 SN=Tin
 Packing A=Tray
 T=Tube

Item	Pitch	Mating
Standard	1.778	3513
Alternate		

Recommended P.C.B Layout(Top Side)
 (PCB BOARD TOLERANCE±0.05)

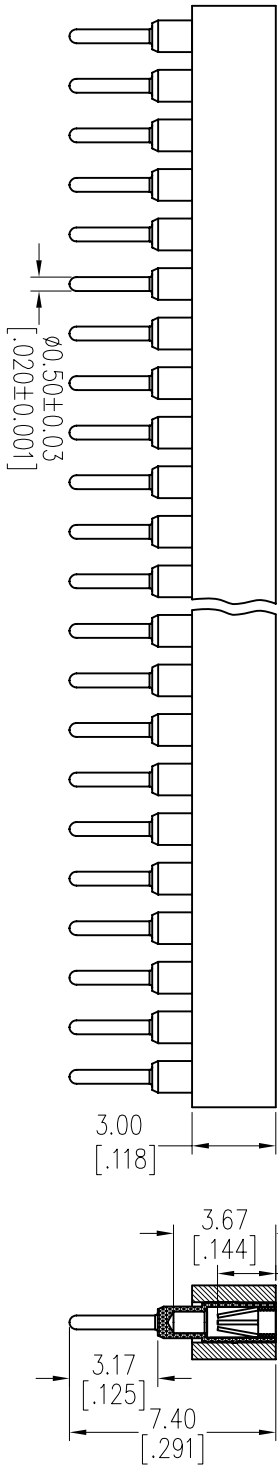
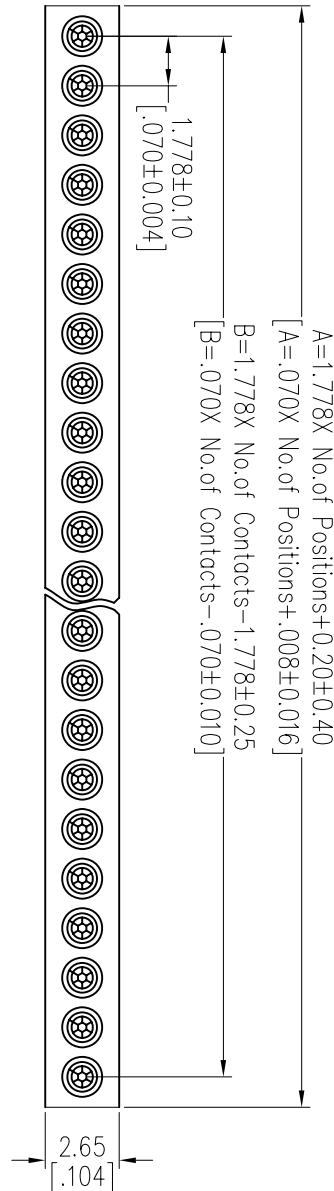

REV	DATE	MODIFICATION DESCRIPTION	CHANGE	OPERATION	DRAW	DATE	SCALE	FIT	PART NO.
A0	2012/10/17	NEW	-----	XX	JYHuang	2012/10/17	UNIT	mm	3523-301XXSX074X1
			-----	X.XX	CHECK	DATE	SIZE	A4	TITLE:
			-----	X.XXX	±0.15	DATE	SHEET	1/1	1.778mm MACHINED FEMALE HEADER
			-----	Angle	± 3'	DATE	PROJ.	☐	SINGLE ROW 180° H=3.0 L=7.4
			-----	DIM	TOL	DATE			Customer NO.